

THE MODERN SIMPLICITY 16

The Simplicity 16 is our most cost-effective canopy or carport solution, designed with a focus on hassle-free installation, durability, and affordability.

As our entry level system, it offers an economical option for providing shade and shelter at both residential and commercial properties. Capable of extending up to 4 metres, it uses a 16mm lightweight polycarbonate roofing system.



- ✓ Verandas
- ✓ Smoking Shelters
- ✓ Carports
- ✓ Porchs
- ✓ Walkway Canopies
- ✓ Patios



Benefits

All-Aluminium System: The Simplicity 16 is exclusively manufactured from aluminium, ensuring exceptional longevity and effortless maintenance.

Easy Installation: Developed in collaboration with one of the industry's leading extrusion designers, this system combines his extensive expertise with our 25 years of experience to create the simplest fixing system possible, facilitating quick and easy installation.

Impact Resistance: Unlike some systems on the market today that utilise PVC or GRP, our system employs 16mm triple wall polycarbonate sheeting, renowned for its superior impact resistance and snow loading capabilities, ensuring durability and reliability across the UK.

Variable Roof Pitch: Setting itself apart from standard roof kits which only offer a fixed pitch, our system boasts a variable pitch range from 2.5 degrees to 22.5 degrees, providing additional flexibility and adaptability.

Features

Lengths: The canopy lengths can be unlimited.

Available Projections: A maximum of 4m projection.

Integral Guttering: Saves time on installation and creates an attractive, sleek design which is also stronger than external guttering systems.

16mm Structured Polycarbonate Panels: Available in clear, opal, bronze, and heatshield.

High UV Protection: A layer of UV absorber is co-extruded onto our roofing panels to offer high UV protection.

Available Upgrades: Enhance your outdoor living solution with our range of upgrades, including Victorian, Lighting, Heating, Shading, and more.

Standard Colours



RAL 7016
Anthracite Grey
Fine Textured



RAL 9016
White
Semi-Gloss



RAL 9005
Jet Black
Fine Textured

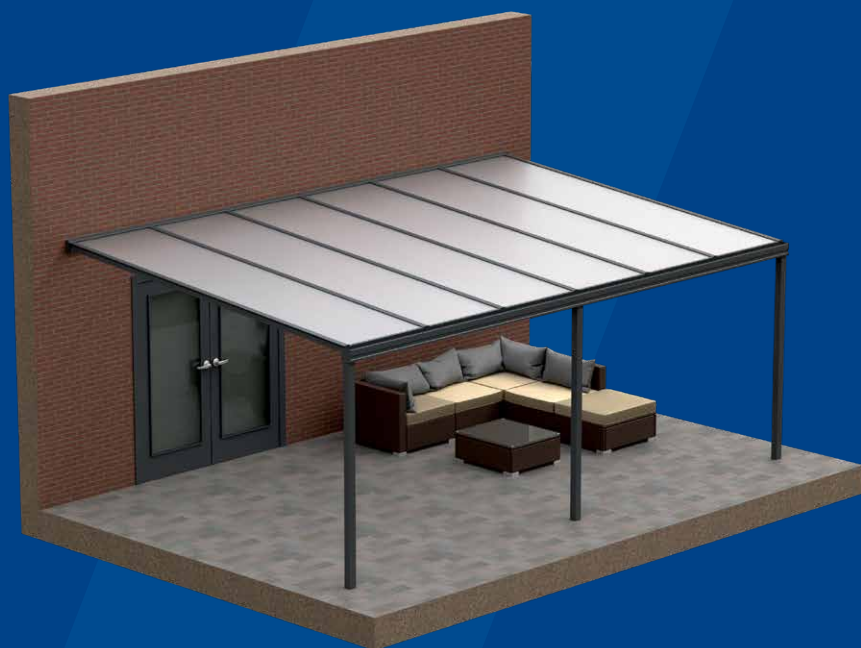

Upgrades

- Victorian Gallow Brackets & Base Castings
- RGBW Lighting in Gutter
- Infrared Heaters
- Multiple Poly Options including Heatshield
- 70x70mm, 70x75mm or 70x100mm Post Sizes
- Privacy Screen